

**MITSUBISHI ELECTRIC**

**GOT2000 Series Protective Sheet for GT27/GT25/GT23/GT2107**

**User's Manual**

GT27-15PSCC GT25-08PSCC  
 GT27-15PSGC GT25-08PSGC  
 GT25-12PSCC GT21-07WPSGC  
 GT25-12PSGC GT25-07WPSGC  
 GT25-12WPSCC GT25-05PSCC  
 GT25-12WPSCC GT25-05PSGC  
 GT25-10PSCC GT25-05PSCC-2  
 GT25-10PSGC GT25-05PSGC-2  
 GT25-10WPSCC GT25-12PSCC-UC  
 GT25-10WPSGC GT25-10PSCC-UC  
 GT25-08PSCC-UC

Thank you for purchasing Mitsubishi Electric Graphic Operation Terminal.

**Prior to use, please read both this manual and detailed manual thoroughly to fully understand the product.**

MODEL	GT27/GT25-PS-U-JE
MODEL CODE	1D7MH9
IB(NA)-0800499-G(2101)MEE	

© 2013 MITSUBISHI ELECTRIC CORPORATION

**SAFETY PRECAUTIONS**

(Always read these precautions before using this equipment.)

Before using this product, please read this manual and the relevant manuals introduced in this manual carefully and pay full attention to safety to handle the product correctly.

The precautions given in this manual are concerned with this product. In this manual, the safety precautions are ranked as "WARNING" and "CAUTION".

**WARNING** Indicates that incorrect handling may cause hazardous conditions, resulting in death or severe injury.

**CAUTION** Indicates that incorrect handling may cause hazardous conditions, resulting in medium or slight personal injury or physical damage.

Note that the CAUTION level may lead to a serious accident according to the circumstances. Always follow the precautions of both levels because they are important to personal safety. Please save this manual to make it accessible when required and always forward it to the end user.

**INSTALLATION PRECAUTIONS**

**CAUTION**

- When attaching the protective sheet onto the GOT display section, make sure to fit the protective sheet onto the section closely without leaving any air between them. Failure to do so may cause a malfunction!

**STARTUP AND MAINTENANCE PRECAUTIONS**

**WARNING**

- Daily check the protective sheet with eyes. When you find extreme dirt or scratches on the surface, immediately replace it with new one. Using the protective sheet of decreased visibility may cause a malfunction.

## 4. INSTALLATION AND REMOVAL

For attaching and removing the protective sheet, refer to the example of the GT2712.

- If the old protective sheet is attached, slowly remove the sheet from the finger grip part of the lower right of the GOT. Clean the GOT surface.

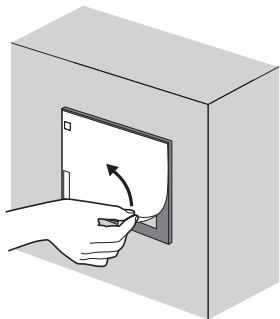

- Peel the release paper off the back of the new protective sheet. Position the hole for the USB environmental protection cover of the protective sheet to the USB environmental protection cover of the GOT. If the protective sheet without the hole for the USB environmental protection cover is attached, position the sheet from the upper left of the GOT.

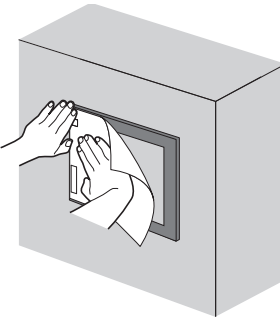

- To attach the protective sheet, attach it from one direction gradually. Make sure to fit the protective sheet onto the joining surface closely without leaving any air between them. Attach the protective sheet with adding additional pressure sufficiently to the adhesive side of the outer circumference. To hold adequate strength of the adhesive joining, use the GOT after a lapse of about 24 hours.

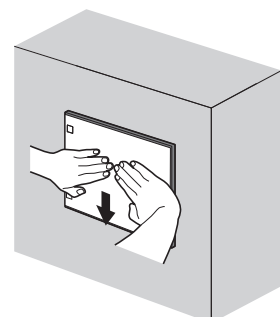

## [DISPOSAL PRECAUTIONS]

**CAUTION**

- Dispose of this product as industrial waste.

## [TRANSPORTATION PRECAUTIONS]

**CAUTION**

- When fumigants that contain halogen materials such as fluorine, chlorine, bromine, and iodine are used for disinfecting and protecting wooden packaging from insects, they cause malfunction when entering our products. Please take necessary precautions to ensure that remaining materials from fumigant do not enter our products, or treat packaging with methods other than fumigation (heat method). Additionally, disinfect and protect wood from insects before packing products.

**Manuals**

The following shows manuals relevant to this product.

Manual name	Manual number (Model code)
GOT2000 Series User's Manual (Hardware) (Sold separately)	SH-081194ENG (1D7MJ5)

For detailed manuals and relevant manuals, refer to the e-Manual or PDF manuals stored in the DVD-ROM for the screen design software used.

The latest manuals are also available from MITSUBISHI ELECTRIC FA Global Website (www.MitsubishiElectric.com/fa).

**Referenced Standard: GB/T15969.2 (Requirement of Chinese standardized law)**

**Packing List**

After unpacking the box, check that the following products are included.

Model	Product	Quantity
GT27-15PSCC GT27-15PSGC GT25-12PSCC GT25-12PSGC GT25-10PSCC GT25-10PSGC GT25-10WPSCC GT25-10WPSGC GT25-08PSCC GT25-08PSGC GT21-07WPSGC GT21-07WPSGC GT25-05PSCC GT25-05PSGC GT25-05PSCC-2 GT25-05PSGC-2 GT25-12PSCC-UC GT25-10PSCC-UC GT25-08PSCC-UC	GOT2000 series protective sheet	5
GT27-15PSCC GT27-15PSGC GT25-12PSCC GT25-12PSGC GT25-10PSCC GT25-10PSGC GT25-10WPSCC GT25-10WPSGC GT25-08PSCC GT25-08PSGC GT21-07WPSGC GT21-07WPSGC GT25-05PSCC GT25-05PSGC GT25-05PSCC-2 GT25-05PSGC-2 GT25-12PSCC-UC GT25-10PSCC-UC GT25-08PSCC-UC	GOT2000 Series Protective Sheet for GT27/GT25/GT23/GT2107 User's Manual (This manual)	1

## 1. OVERVIEW

This User's Manual describes GOT 2000 series protective sheet (hereinafter referred to as the protective sheet). Use the protective sheet to protect the display section surface from scratches and dirt when operating the touch keys on the GOT display section.

## 2. SPECIFICATIONS

The following shows the performance specifications and models of the protective sheets, and applicable GOT screen sizes. The general specifications for the protective sheet are the same as those of the GOT. For the general specifications of the GOT, refer to the GOT2000 Series User's Manual (Hardware).

The clear protective sheets and the antiglare protective sheets are available. The clear protective sheets have excellent transparency and do not reduce the brightness of the GOT screen. The antiglare protective sheets are anti-reflection coated and suitable for use in an environment where the GOT screen is difficult to see because of the reflected light.

Product	Model	Description
Protective sheet	GT27-15PSGC	For 15"
	GT25-12PSGC	For 12.1"
	GT25-10PSGC	For 10.4"
	GT25-08PSGC	For 8.4"
	GT25-05PSGC	For 5.7" (GT2705)
	GT25-05PSCC-2	For 5.7" (GT2505)
	GT25-12WPSCC	For 12.1" Wide
	GT25-10WPSCC	For 10.1" Wide
	GT21-07WPSGC	For 7" Wide
	GT27-15PSCC	For 15"
	GT25-12PSCC	For 12.1"
	GT25-10PSCC	For 10.4"
	GT25-08PSCC	For 8.4"
	GT25-05PSCC	For 5.7" (GT2705)
	GT25-05PSCC-2	For 5.7" (GT2505)
	GT25-12WPSCC	For 12.1" Wide
	GT25-10WPSCC	For 10.1" Wide
	GT21-07WPSCC	For 7" Wide
GT25-12PSCC-UC	For 12.1"	
GT25-10PSCC-UC	For 10.4"	
GT25-08PSCC-UC	For 8.4"	

Antiglare type  
 • Transparent  
 • With a hole for the USB environmental protection cover

Clear type  
 • Transparent  
 • Without a hole for the USB environmental protection cover\*1

\*1: The protective sheet is shaped not to cover the USB environmental protection cover.

## 3. EXTERNAL DIMENSIONS

- GT27-15PSCC, GT27-15PSGC, GT25-12PSCC, GT25-12PSGC, GT25-10PSCC, GT25-10PSGC, GT25-08PSCC, GT25-08PSGC, GT25-05PSCC, GT25-05PSGC

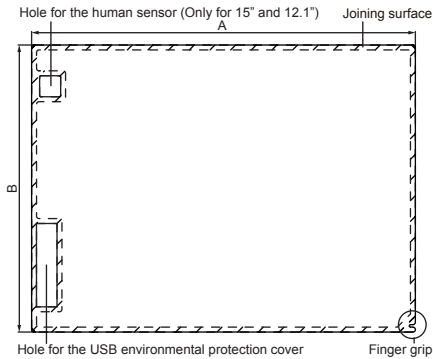

- GT25-12WPSCC, GT25-12WPSGC, GT25-10WPSCC, GT25-10WPSGC, GT21-07WPSCC, GT21-07WPSGC, GT25-12PSCC-UC, GT25-10PSCC-UC, GT25-08PSCC-UC

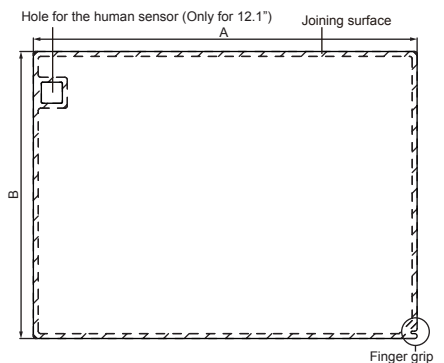

- GT25-05PSCC-2, GT25-05PSGC-2

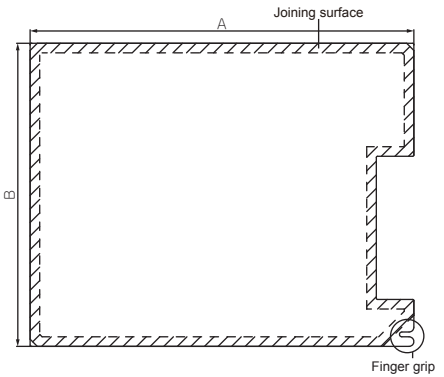

Item	A	B
15" protective sheet	392(15.4)	287(11.3)
12.1" protective sheet	312(12.3)	234(9.21)
12.1" Wide protective sheet	297(11.7)	198(7.80)
10.4" protective sheet	299(11.8)	206(8.11)
10.1" Wide protective sheet	250(9.84)	173(6.81)
8.4" protective sheet	237(9.33)	182(7.17)
7" Wide protective sheet	187(7.36)	121(4.76)
5.7" protective sheet (for GT2705)	163(6.42)	127(5.00)
5.7" protective sheet (for GT2505)	160(6.30)	127(5.00)

Unit: mm (inch)

## 5. PRECAUTIONS FOR USE

- The protective sheet is consumable supplies. If you find scratches or extreme dirt by the periodic check, replace it with new one.
- Do not push the protective sheet with something whose point is sharp, such as a mechanical pencil or screwdriver. Doing so may cause scratches or be damaged.
- Do not wash the protective sheet with using bleach, thinner, organic solvent, caustic chemical, and others. Doing so may change in shape or color.
- Do not expose the protective sheet to direct sunlight. If the protective sheet gets dust, wipe the sheet with a damp cloth.
- When using GT25-05PSCC-2 or GT25-05PSGC-2, remove the protective film from the sheet surface.

## Warranty

Mitsubishi Electric will not be held liable for damage caused by factors found not to be the cause of Mitsubishi Electric; machine damage or lost profits caused by faults in the Mitsubishi Electric products; damage, secondary damage, accident compensation caused by special factors unpredictable by Mitsubishi Electric; damages to products other than Mitsubishi Electric products; and to other duties.

### For safe use

- This product has been manufactured as a general-purpose part for general industries, and has not been designed or manufactured to be incorporated in a device or system used in purposes related to human life.
- Before using the product for special purposes such as nuclear power, electric power, aerospace, medicine or passenger movement vehicles, consult with Mitsubishi Electric.
- This product has been manufactured under strict quality control. However, when installing the product where major accidents or losses could occur if the product fails, install appropriate backup or failsafe functions in the system.

Country/Region	Sales office/Tel
USA	Mitsubishi Electric Automation, Inc. 500 Corporate Woods Parkway, Vernon Hills, IL 60061, U.S.A. Tel: +1-847-478-2100
Brazil	Mitsubishi Electric do Brasil Comercio e Servicos Ltda. Avenida Adelfino Cardana, 293, 21 andar, Bethaville, Banerji SP, Brazil Tel: +55-11-4689-3000
Mexico	Mitsubishi Electric Automation, Inc. Mexico Branch Boulevard Miguel de Cervantes Saavedra 301, Torre Norte Piso 5, Ampliacion Granada, Miguel Hidalgo, Ciudad de Mexico, Mexico, C.P.11520 Tel: +52-55-3067-7512
Germany	Mitsubishi Electric Europe B.V. German Branch Mitsubishi-Electric-Platz 1, 40882 Ratingen, Germany Tel: +49-2102-486-0
UK	Mitsubishi Electric Europe B.V. UK Branch Travellers Lane, UK-Hatfield, Hertfordshire, AL10 8XB, U.K. Tel: +44-1707-28-8780
Italy	Mitsubishi Electric Europe B.V. Italian Branch Centro Direzionale Colleoni - Palazzo Siro, Viale Colleoni 7, 20864 Agrate Brianza (MB), Italy Tel: +39-039-60531
Spain	Mitsubishi Electric Europe B.V. Spanish Branch Carretera de Rubi, 76-80-Appdo. 420, E-08190 Sant Cugat del Valles (Barcelona), Spain Tel: +34-935-65-3131
France	Mitsubishi Electric Europe B.V. French Branch 25, Boulevard des Bouvets, 92741 Nanterre Cedex, France Tel: +33-1-55-68-55-68
Czech	Mitsubishi Electric Europe B.V. Czech Branch Pekarska 62/77, 155 00 Praha 5, Czech Republic Tel: +420-255 719 200
Turkey	Mitsubishi Electric Turkey A.S. Umraniye Branch Serifali Mahallesi Nispetiye Sokak No 5, TR-34775 Umraniye / Istanbul, Turkey Tel: +90-216-526-3990
Poland	Mitsubishi Electric Europe B.V. Polish Branch ul. Krakowska 48, 32-083 Balice, Poland Tel: +48-12-347-65-00
Russia	Mitsubishi Electric (Russia) LLC St. Petersburg Branch Piskarevsky pr. 2, bld 2, "Sich", BC "Benua", office 720, 195027 St. Petersburg, Russia Tel: +7-812-633-3497
South Africa	Adroit Technologies 20 Waterford Office Park, 189 Witkoppen Road, Fourways, South Africa Tel: +27-11-658-8100
China	Mitsubishi Electric Automation (China) Ltd. Mitsubishi Electric Automation Center, No.1386 Hongqiao Road, Shanghai, China Tel: +86-21-2322-3030
Taiwan	SETSUYO ENTERPRISE CO., LTD. 8F, No. 105, Wugong 3rd Road, Wugu District, New Taipei City 24889, Taiwan Tel: +886-2-2299-2499
Korea	Mitsubishi Electric Automation Korea Co., Ltd. 7F to 9F, Gangseo Hangang Xi-lower A, 401, Yangcheon-ro, Gangseo-Gu, Seoul 07528, Korea Tel: +82-2-3660-9569
Singapore	Mitsubishi Electric Asia Pte. Ltd. 307 Alexandra Road, Mitsubishi Electric Building, Singapore 159943 Tel: +65-6473-2308
Thailand	Mitsubishi Electric Factory Automation (Thailand) Co., Ltd. 12th Floor, SV City Building, Office Tower 1, No. 896/19 and 20 Rama 3 Road, Kwaeng Bangpongpan, Khet Yannawa, Bangkok 10120, Thailand Tel: +66-2682-6522 to 31
Indonesia	PT Mitsubishi Electric Indonesia Gedung Jaya 8th Floor, JL. MH. Thamrin No.12, Jakarta Pusat 10340, Indonesia Tel: +62-21 3192-6481
Vietnam	Mitsubishi Electric Vietnam Company Limited 11th & 12th Floor, Viettel Tower B, 285 Cach Mang Thang 8 Street, Ward 12, District 10, Ho Chi Minh City, Vietnam. Tel: +84-28-3910-5945
India	Mitsubishi Electric India Pvt. Ltd. Pune Branch Emerald House, EL-3, J Block, M.I.D.C., Bhosari, Pune - 411026, Maharashtra, India Tel: +91-20-2710-2000
Australia	MITSUBISHI ELECTRIC AUSTRALIA PTY. LTD. 348 Victoria Road, P.O. Box 11, Rydalmere, N.S.W 2116, Australia Tel: +61-2-9684-7777

**MITSUBISHI ELECTRIC CORPORATION**  
 HEAD OFFICE: TOKYO BUILDING, 2-7-3 MARUNOUCHI, CHIYODA-KU, TOKYO 100-8310, JAPAN  
 NAGOYA WORKS: 1-14, YADA-MINAMI 5-CHOME, HIGASHI-KU, NAGOYA, JAPAN

When exported from Japan, this manual does not require application to the Ministry of Economy, Trade and Industry for service transaction permission.  
 Specifications subject to change without notice.  
 Printed in Japan, January 2021.