



Side A JAPANESE
Side B ENGLISH

FX3U-7DM

USER'S MANUAL



Manual Number	JY997D17101
Revision	F
Date	January 2018

This manual describes the part names, dimensions, mounting, and specifications of the product. Before use, read this manual and the manuals of all relevant products fully to acquire proficiency in handling and operating the product. Make sure to learn all the product information, safety information, and precautions. Store this manual in a safe place so that it can be taken out and read whenever necessary. Always forward it to the end user.

Registration:
The company and product names described in this manual are registered trademarks or the trademarks of their respective companies.

Effective January 2018
Specifications are subject to change without notice.
© 2005 Mitsubishi Electric Corporation

Safety Precautions (Read these precautions before use.)

This manual classifies the safety precautions into two categories:

WARNING and **CAUTION**

WARNING	Indicates that incorrect handling may cause hazardous conditions, resulting in death or severe injury.
CAUTION	Indicates that incorrect handling may cause hazardous conditions, resulting in medium or slight personal injury or physical damage.

Depending on the circumstances, procedures indicated by **CAUTION** may also cause severe injury. It is important to follow all precautions for personal safety.

Associated Manuals

Manual name	Manual No.	Description
FX3U-7DM-HLD User's Manual	JY997D15401	Explains the FX3U-7DM-HLD display module holder specifications for external dimensions and installation.
FX3U Series User's Manual - Hardware Edition	JY997D16501 MODEL CODE: 09R516	Explains the FX3U Series PLC specifications for I/O, wiring, installation, and maintenance.
FX3UC Series User's Manual - Hardware Edition	JY997D28701 MODEL CODE: 09R519	Explains the FX3UC Series PLC specifications for I/O, wiring, installation, and maintenance.

For the operation of the display module, refer to the PLC main unit manual.
→ **FX3U Series User's Manual - Hardware Edition**
→ **FX3UC Series User's Manual - Hardware Edition**

How to obtain manuals

For product manuals or documents, consult with the Mitsubishi Electric dealer from who you purchased your product.

Applicable standard

FX3U-7DM units made in May, 2005 or later comply with the EC Directive (EMC Directive). Further information can be found in the following manual. However, the FX3UC-32MT-LT does not comply with the EC Directive (EMC Directive).

→ **FX3U Series Hardware Manual (Manual No. JY997D50301)**
→ **FX3UC-32MT-LT-2 Hardware Manual (Manual No. JY997D31601)**

Attention

This product is designed for use in industrial applications.

1. Outline

The FX3U-7DM display module (hereinafter called display module) is installed to the FX3U / FX3UC-32MT-LT(-2) (provided as standard equipment) PLC main unit to display messages (alphabet, numbers, and Japanese characters) or to monitor/change device states.

1.1 Incorporated Items

Verify that the following product and items are included in the package:

Product	FX3U-7DM display module
Accessories	Display module mounting top cover User's manual (This manual)

1.2 External Dimensions and Part Names

Unit: mm (inches)
MASS (Weight): Display module Approx. 20g (0.05lbs)
Display module mounting top cover Approx. 10g (0.03lbs)

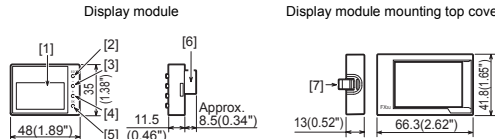

No.	Name	Description
[1]	Display	Displays current time and monitored status of device.
[2]	"ESC" button	Use to cancel operation or return to previous screen.
[3]	"." button	Use to move cursor or set the value.
[4]	"+" button	Use to move cursor or set the value.
[5]	"OK" button	Use to choose the item, set the value, etc.
[6]	Connector for main unit	Used to connect display module to main unit.
[7]	Top cover fixing hook	Fixes the display module installing top cover on PLC.

1.3 Installation Example

Install to main unit

Install to control panel
→ For installation, refer to **FX3U-7DM-HLD User's Manual**.

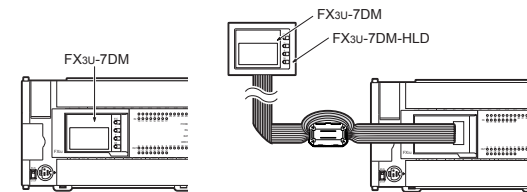

2. Installation and Remove

INSTALLATION PRECAUTIONS **WARNING**

- Make sure to cut off all phases of the power supply externally before attempting installation or wiring work. Failure to do so may cause electric shock or damage to the product.

INSTALLATION PRECAUTIONS **CAUTION**

- Use the product within the generic environment specifications described in PLC main unit manual (Hardware Edition). Never use the product in areas with excessive dust, oily smoke, conductive dusts, corrosive gas (salt air, Cl₂, H₂S, SO₂ or NO₂), flammable gas, vibration or impacts, or expose it to high temperature, condensation, or rain and wind. If the product is used in such conditions, electric shock, fire, malfunctions, deterioration or damage may occur.
- Do not touch the conductive parts of the product directly. Doing so may cause device failures or malfunctions.
- Connect display module securely to their designated connectors. Loose connections may cause malfunctions.

The following section describes the installation method for the FX3U/FX3UC-32MT-LT(-2) Series PLC (FX3U Series PLC is used for the following example).

For more details on installation and removal, refer to the PLC main unit manual.
→ **FX3U Series User's Manual - Hardware Edition**
→ **FX3UC Series User's Manual - Hardware Edition**

- Power off the PLC.
- Pushing the top cover hook (fig. A), remove the top cover (fig. B), as shown in the right figure.

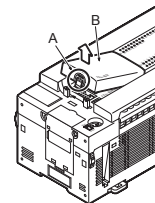

- When installing
Install the display module (fig. C) to E on the main unit (fig. D) as indicated with the arrow 3). When removing
Remove the display module (fig. C) from the main unit (fig. D) as indicated with the arrow 3').

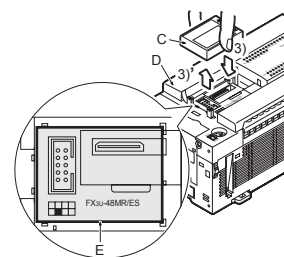

- Place the G side of the display module mounting top cover (fig. F) onto the main unit (fig. D).
- The display module mounting top cover (fig. F) is installed in the Main module (fig. D) as shown in the right figure.

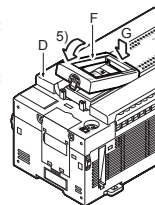

3. Specifications

STARTUP AND MAINTENANCE PRECAUTIONS **CAUTION**

- Do not disassemble or modify the PLC. Doing so may cause fire, equipment failures, or malfunctions. * For repair, contact your local Mitsubishi Electric representative.
- Do not drop the product or exert strong impact to it. Doing so may cause damage.

DISPOSAL PRECAUTIONS **CAUTION**

- Please contact a certified electronic waste disposal company for the environmentally safe recycling and disposal of your device.

TRANSPORTATION AND STORAGE PRECAUTIONS **CAUTION**

- The product is a precision instrument. During transportation, avoid impacts larger than those specified in the general specifications by using dedicated packaging boxes and shock-absorbing palettes. Failure to do so may cause failures in the product. After transportation, verify operation of the product and check for damage of the mounting part, etc.

3.1 Applicable PLC

Model	Applicability
FX3U Series PLC	Ver. 2.20 or later (from first production)
FX3UC-32MT-LT*	Ver. 1.00 or later (from first production)
FX3UC-32MT-LT-2*	Ver. 2.53 or later (from first production)

* FX3UC-32MT-LT(-2) has this display module provided as standard equipment.

3.2 Display Specifications

Item	Description
Display device/ backlight	STN monochrome liquid crystal display/ Backlight: LED (green)
Displayed letters	Number of letters
	Character

16 letters × 4 lines (2 byte letter: 8 letters × 4 lines)
Alphabets, Numbers, Japanese character, Shift JIS Level-1, 2

Item	Description
Displayed letters	Language for menu display
Button	4 operation buttons (OK, ESC, +, and -)

3.3 General Specifications

The general specifications are equivalent to the PLC main unit. For general specifications, refer to the following manuals.
→ **FX3U Series User's Manual - Hardware Edition**
→ **FX3UC Series User's Manual - Hardware Edition**

3.4 Power Supply Specifications

5V DC, 20 mA is supplied from the internal power supply of the main unit.

4. Function List

For the function list, refer to the PLC main unit manual.
→ **FX3U Series User's Manual - Hardware Edition**
→ **FX3UC Series User's Manual - Hardware Edition**

「电器电子产品有害物质限制使用标识要求」的表示方式

15 Note: This symbol mark is for China only.

含有有害6物质的名称, 含有量, 含有部品
本产品中所含有的有害6物质的名称, 含有量, 含有部品如下表所示。

产品中有害物质的名称及含量

部品名称	有害物质					
	铅 (Pb)	汞 (Hg)	镉 (Cd)	六价铬 (Cr (VI))	多溴联苯 (PBB)	多溴二苯醚 (PBDE)
可编程控制器	○	○	○	○	○	○
外壳	○	○	○	○	○	○
印刷基板	×	○	○	○	○	○

本表格依据SJ/T 11364的规定编制。

○:表示该有害物质在该部件所有均质材料中的含量均在GB/T 26572规定的限量要求以下。
×:表示该有害物质至少在该部件的某一均质材料中的含量超出GB/T 26572规定的限量要求。

This manual confers no industrial property rights or any rights of any other kind, nor does it confer any patent licenses. Mitsubishi Electric Corporation cannot be held responsible for any problems involving industrial property rights which may occur as a result of using the contents noted in this manual.

Warranty
Exclusion of loss in opportunity and secondary loss from warranty liability
Regardless of the gratis warranty term, Mitsubishi shall not be liable for compensation to:
(1) Damages caused by any cause found not to be the responsibility of Mitsubishi.
(2) Loss in opportunity, lost profits incurred to the user by Failures of Mitsubishi products.
(3) Special damages and secondary damages whether foreseeable or not, compensation for accidents, and compensation for damages to products other than Mitsubishi products.
(4) Replacement by the user, maintenance of on-site equipment, start-up test run and other tasks.

For safe use

- This product has been manufactured as a general-purpose part for general industries, and has not been designed or manufactured to be incorporated in a device or system used in purposes related to human life.
- Before using the product for special purposes such as nuclear power, electric power, aerospace, medicine or passenger movement vehicles, consult with Mitsubishi Electric.
- This product has been manufactured under strict quality control. However when installing the product where major accidents or losses could occur if the product fails, install appropriate backup or failsafe functions in the system.