

**MITSUBISHI ELECTRIC**

## GOT2000 Series Antibacterial/Antiviral Protective Sheet for GT27/GT25

### User's Manual

**GT25-12PSAC  
GT25-10PSAC  
GT25-08PSAC**

Thank you for purchasing Mitsubishi Electric Graphic Operation Terminal.

**Prior to use, please read both this manual and detailed manual thoroughly to fully understand the product.**

MODEL	GT27/GT25-PSAC-U-JE
MODEL CODE	1D7MW5
IB(NA)-0800666-B(2307)MEE	

© 2021 MITSUBISHI ELECTRIC CORPORATION

#### SAFETY PRECAUTIONS

(Always read these precautions before using this equipment.)

Before using this product, please read this manual and the relevant manuals introduced in this manual carefully and pay full attention to safety to handle the product correctly.

The precautions given in this manual are concerned with this product. In this manual, the safety precautions are ranked as "WARNING" and "CAUTION".

**WARNING** Indicates that incorrect handling may cause hazardous conditions, resulting in death or severe injury.

**CAUTION** Indicates that incorrect handling may cause hazardous conditions, resulting in medium or slight personal injury or physical damage.

Note that the CAUTION level may lead to a serious accident according to the circumstances.

Always follow the precautions of both levels because they are important to personal safety.

Please save this manual to make it accessible when required and always forward it to the end user.

#### INSTALLATION PRECAUTIONS

**CAUTION**

- When attaching the protective sheet onto the GOT display section, make sure to fit the protective sheet onto the section closely without leaving any air between them. Failure to do so may cause a malfunction.
- When attaching or removing the antibacterial/antiviral protective sheet, do not bend the sheet. Doing so may cause the sheet to become cracked.

#### STARTUP AND MAINTENANCE PRECAUTIONS

**WARNING**

- Daily check the protective sheet with eyes. When you find extreme dirt or scratches on the surface, immediately replace it with new one. Using the protective sheet of decreased visibility may cause a malfunction.

#### DISPOSAL PRECAUTIONS

**CAUTION**

- Dispose of this product as industrial waste.

## 4. INSTALLATION AND REMOVAL

For attaching and removing the antibacterial protective sheet, refer to the example of the GT2712.

When attaching or removing the antibacterial protective sheet, do not bend the sheet. Doing so may cause the sheet to become cracked.

- If a protective sheet or an antibacterial protective sheet is attached, carefully remove the sheet from the lower right corner of the GOT. Clean the GOT surface.

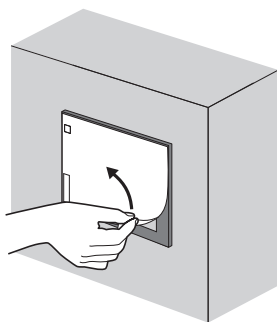

- Peel the release paper off the back of the new antibacterial protective sheet. Position the sheet from the upper left corner of the GOT.

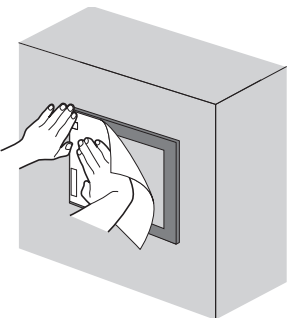

- To attach the antibacterial protective sheet, attach it from one direction gradually. Make sure to fit the antibacterial protective sheet onto the joining surface closely without leaving any air between them. Attach the antibacterial protective sheet with adding additional pressure sufficiently to the adhesive side of the outer circumference. To secure adequate strength of the adhesive joining, it is recommended to start using the GOT about 24 hours after attaching the sheet.

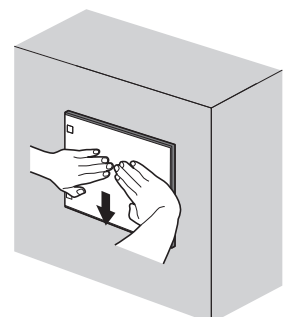

## TRANSPORTATION PRECAUTIONS

**CAUTION**

- When fumigants that contain halogen materials such as fluorine, chlorine, bromine, and iodine are used for disinfecting and protecting wooden packaging from insects, they cause malfunction when entering our products. Please take necessary precautions to ensure that remaining materials from fumigant do not enter our products, or treat packaging with methods other than fumigation (heat method). Additionally, disinfect and protect wood from insects before packing products.

**Manuals**

The following shows manuals relevant to this product.

Manual name	Manual number (Model code)
GOT2000 Series User's Manual (Hardware) (Sold separately)	SH-081194ENG (1D7MJ5)

For the latest e-Manuals and PDF manuals, consult your local sales office.

Referenced Standard: GB/T15969.2 (Requirement of Chinese standardized law)

**Packing List**  
After unpacking the box, check that the following products are included.

Model	Product	Quantity
GT25-12PSAC	GOT2000 Series Antibacterial/Antiviral Protective Sheet	5
GT25-10PSAC GT25-08PSAC	GOT2000 Series Antibacterial/Antiviral Protective Sheet for GT27/GT25 User's Manual (This manual)	1

Product	Model	Description
Antibacterial/Antiviral Protective Sheet	GT25-12PSAC	For 12.1"
	GT25-10PSAC	For 10.4"
	GT25-08PSAC	For 8.4"

## 1. OVERVIEW

This user's manual describes GOT2000 series antibacterial/antiviral protective sheet (hereafter referred to as the antibacterial protective sheet). The antibacterial protective sheet uses the antiviral/antibacterial RIKEGUARD® of RIKEN TECHNOS CORPORATION. The sheet protects the GOT screen from scratches and dirt when you operate touch keys. The clear protective sheet has excellent transparency and does not reduce the brightness of the GOT screen.

\*1 RIKEGUARD® is a registered trademark of RIKEN TECHNOS CORPORATION.



## 2. SPECIFICATIONS

### 2.1 General Specifications

The general specifications for the antibacterial protective sheet are the same as those of the GOT. For the general specifications of the GOT, refer to the GOT2000 Series User's Manual (Hardware).

### 2.2 Performance Specifications

The following shows the performance specifications and models of the antibacterial protective sheets, and applicable GOT screen sizes. The antibacterial protective sheet is not available for the open frame models and wide models.

Product	Model	Description
Antibacterial/Antiviral Protective Sheet	GT25-12PSAC	For 12.1"
	GT25-10PSAC	For 10.4"
	GT25-08PSAC	For 8.4"

### 2.3 About Antiviral

- Inorganic antiviral agent, kneading, surface layer: JP00612310A0003R
- The SIAA mark is displayed on products that are subject to quality control and information disclosure in accordance with the guidelines of the Society of International sustaining growth for Antimicrobial Articles (SIAA), based on the results of evaluation in accordance with the ISO 21702 method.
- This product is not a pharmaceutical product.
- It does not reduce all viruses.
- It uses antiviral materials that meet the safety standards of SIAA.
- It meets the safety standards of SIAA.
- Antiviral processing is not intended to treat or prevent disease.

### 2.4 About Antibacterial

- Inorganic antibacterial agent, kneading, surface layer: JP0122310A0004O
- The SIAA mark is displayed on products that are subject to quality control and information disclosure in accordance with the guidelines of the Society of International sustaining growth for Antimicrobial Articles (SIAA), based on the results of evaluation in accordance with the ISO 22196 method.
- This product is not a pharmaceutical product.
- It does not inactivate all bacteria.
- It uses antibacterial materials that meet the safety standards of SIAA.

## 3. EXTERNAL DIMENSIONS

- GT25-12PSAC

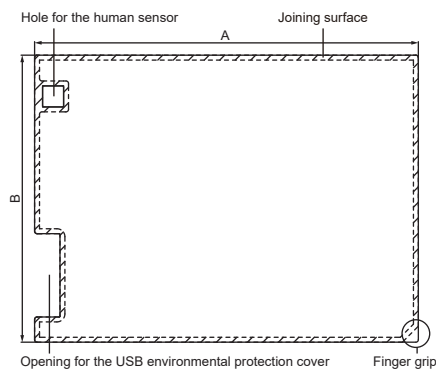

- GT25-10PSAC, GT25-08PSAC

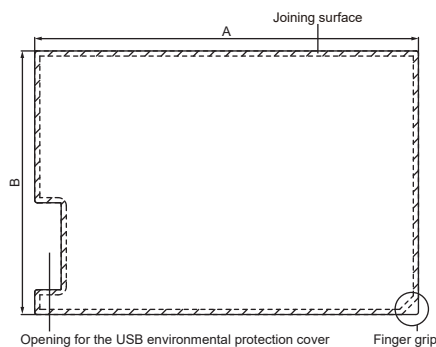

Model	A	B
GT25-12PSAC	312.1(12.29)	233.5(9.19)
GT25-10PSAC	299.1(11.78)	205.5(8.09)
GT25-08PSAC	237.1(9.33)	181.5(7.15)

Unit: mm (inch)

## 5. PRECAUTIONS FOR USE

- The antibacterial protective sheet is consumable supplies. If you find scratches or extreme dirt by the periodic check, replace it with new one.
- Do not expose the antibacterial protective sheet to direct sunlight.
- Do not push the antibacterial protective sheet with a pointed object such as a mechanical pencil or screwdriver. Doing so may scratch or damage the sheet.
- Wipe off any water droplets on the surface of the antibacterial protective sheet. If they remain, there may be traces, etc. of chlorine in tap water.
- If the antibacterial protective sheet gets any dirt, etc., wipe it off lightly with a soft cloth. At this time, do not use solvents such as nail polish remover, benzene, thinner, bleach, or abrasives. Do not use hypochlorous acid water used for disinfection of hospital equipment, etc. This may cause discoloration.
- If the antibacterial sheet is heavily dirty, soap a soft cloth with water and household soap, wipe the surface gently, then wipe it off with a clean, soft cloth and dry it. When using alcohol, wipe it off with a soft cloth impregnated with ethanol, which is commonly used to disinfect hands, etc., then wipe it off with a dry soft cloth and dry it. Use of other alcohols may cause discoloration.

## Warranty

Mitsubishi Electric will not be held liable for damage caused by factors found not to be the cause of Mitsubishi Electric; machine damage or lost profits caused by faults in the Mitsubishi Electric products; damage, secondary damage, accident compensation caused by special factors unpredictable by Mitsubishi Electric; damages to products other than Mitsubishi Electric products; and to other duties.

### For safe use

- This product has been manufactured as a general-purpose part for general industries, and has not been designed or manufactured to be incorporated in a device or system used in purposes related to human life.
- Before using the product for special purposes such as nuclear power, electric power, aerospace, medicine or passenger movement vehicles, consult with Mitsubishi Electric.
- This product has been manufactured under strict quality control. However, when installing the product where major accidents or losses could occur if the product fails, install appropriate backup or failsafe functions in the system.

### Sales office/Tel

Americas
Mitsubishi Electric Automation, Inc. 500 Corporate Woods Parkway, Vernon Hills, IL 60061, U.S.A. Tel: +1-847-478-2100
Mitsubishi Electric do Brasil Comercio e Servicos Ltda. Avenida Adelino Cardana, 293, 21 andar, Bethaville, Banerji SP, Brazil Tel: +55-11-4689-3000
Mitsubishi Electric Automation, Inc. Mexico Branch Boulevard Miguel de Cervantes Saavedra 301, Torre Norte Piso 5, Ampliacion Granada, Miguel Hidalgo, Ciudad de Mexico, Mexico, C.P.11520 Tel: +52-55-3067-7512
Europe
Mitsubishi Electric Europe B.V. German Branch Mitsubishi-Electric-Platz 1, 40882 Ratingen, Germany Tel: +49-2102-486-0
Mitsubishi Electric Europe B.V. UK Branch Travellers Lane, UK-Hatfield, Hertfordshire, AL10 8XB, U.K. Tel: +44-1707-28-8780
Mitsubishi Electric Europe B.V. Italian Branch Centro Direzionale Collettoni - Palazzo Sirio, Viale Collettoni 7, 20864 Agrate Brianza (MB), Italy Tel: +39-039-60531
Mitsubishi Electric Europe B.V. Spanish Branch Carretera de Rubi, 75-80-Appdo. 420, E-08190 Sant Cugat del Valles (Barcelona), Spain Tel: +34-935-65-3131
Mitsubishi Electric Europe B.V. French Branch 25, Boulevard des Bouvets, 92741 Nanterre Cedex, France Tel: +33-1-55-88-55-68
Mitsubishi Electric Europe B.V. Czech Branch Pekarska 62/17, 155 00 Praha 5, Czech Republic Tel: +420-255 719 200
Mitsubishi Electric Turkey A.S. Umranije Branch Serifali Mahallesi Nutuk Sokak No:5, TR-34775 Umranije / Istanbul, Turkey Tel: +90-216-526-9990
Mitsubishi Electric Europe B.V. Polish Branch ul. Krakowska 48, 32-083 Balice, Poland Tel: +48-12-347-65-00
Africa
Adroit Technologies 20 Waterford Office Park, 189 Witkoppen Road, Fourways, South Africa Tel: +27-11-658-8100
Asia-Pacific
Mitsubishi Electric Automation (China) Ltd. Mitsubishi Electric Automation Center, No.1386 Hongqiao Road, Shanghai, China Tel: +86-21-2322-3030
SETSUYO ENTERPRISE CO., LTD. 8F, No.105, Wugong 3rd Road, Wugu District, New Taipei City 24889, Taiwan Tel: +886-2-2299-2499
Mitsubishi Electric Automation Korea Co., Ltd. 7F to 9F, Gangseo Hangang Xi-tower A, 401, Yangcheon-ro, Gangseo-Gu, Seoul 07528, Korea Tel: +82-2-3650-9690
Mitsubishi Electric Asia Pte. Ltd. 307 Alexandra Road, Mitsubishi Electric Building, Singapore 159943 Tel: +65-6473-2308
Mitsubishi Electric Factory Automation (Thailand) Co., Ltd. 12th Floor, SV City Building, Office Tower 1, No. 896/19 and 20 Rama 3 Road, Kwaeng Bangpongpan, Khet Yannawa, Bangkok 10120, Thailand Tel: +66-2682-6522 to 31
PT. Mitsubishi Electric Indonesia Gedung Jaya 8th Floor, JI. MH. Thamrin No.12, Jakarta Pusat 10340, Indonesia Tel: +62-21 3192-6461
Mitsubishi Electric Vietnam Company Limited 11th & 12th Floor, Viettel Tower B, 285 Cach Mang Thang 8 Street, Ward 12, District 10, Ho Chi Minh City, Vietnam. Tel: +84-28-3910-5945
Mitsubishi Electric India Pvt. Ltd. Pune Branch Emerald House, EL-3, J Block, M.I.D.C., Bhosari, Pune - 411026, Maharashtra, India Tel: +91-20-2710-2000
MITSUBISHI ELECTRIC AUSTRALIA PTY. LTD. 348 Victoria Road, P.O. Box 11, Rydalmore, N.S.W 2116, Australia Tel: +61-2-9684-7777

## MITSUBISHI ELECTRIC CORPORATION

HEAD OFFICE: TOKYO BLDG. 2-7-3, MARUNOUCHI, CHIYODA-KU, TOKYO 100-8310, JAPAN  
NAGOYA WORKS: 1-14, YADA-MINAMI 5-CHOME, HIGASHI-KU, NAGOYA 461-8670, JAPAN

When exported from Japan, this manual does not require application to the Ministry of Economy, Trade and Industry for service transaction permission.

Specifications subject to change without notice.  
Printed in Japan, July 2023.