

MITSUBISHI

GOT1000 Series CF Card /Memory Card Adaptor

User's Manual

- | | |
|----------------|---------------|
| GT05-MEM-16MC | GT05-MEM-1GC |
| GT05-MEM-32MC | GT05-MEM-2GC |
| GT05-MEM-64MC | GT05-MEM-4GC |
| GT05-MEM-128MC | GT05-MEM-8GC |
| GT05-MEM-256MC | GT05-MEM-16GC |
| GT05-MEM-512MC | GT05-MEM-ADPC |

Thank you for purchasing the GOT1000 Series.

Prior to use, please read both this manual and detailed manual thoroughly to fully understand the product.

| | |
|---------------------------|------------|
| MODEL | GT05-MEM-U |
| MODEL CODE | 1D7M08 |
| IB(NA)-0800302-H(1104)MEE | |

GRAPHIC OPERATION TERMINAL
GOT1000

SAFETY PRECAUTIONS

(Always read these precautions before using this equipment.)

Before using this product, please read this manual and the relevant manuals introduced in this manual carefully and pay full attention to safety to handle the product correctly. The precautions given in this manual are concerned with this product.

In this manual, the safety precautions are ranked as "DANGER" and "CAUTION".

DANGER Indicates that incorrect handling may cause hazardous conditions, resulting in death or severe injury.

CAUTION Indicates that incorrect handling may cause hazardous conditions, resulting in medium or slight personal injury or physical damage.

Note that the CAUTION level may lead to a serious accident according to the circumstances.

Always follow the precautions of both levels because they are important to personal safety.

Please save this manual to make it accessible when required and always forward it to the end user.

TRANSPORTATION PRECAUTIONS

CAUTION

- Make sure to transport the GOT main unit and/or relevant unit(s) in the manner they will not be exposed to the impact exceeding the impact resistance described in the general specifications of the User's Manual for the GOT used, as they are precision devices. Failure to do so may cause the unit to fail. Check if the unit operates correctly after transportation.

INSTALLING PRECAUTIONS

CAUTION

- Before installing/removing the CF card into/from the GOT, be sure to set the CF card access switch to OFF to turn off the CF card access LED. Failure to do so may cause data corruption or malfunction.
- When ejecting the CF card, support it by hand since it may pop out. Failure to do so may cause a fall of the CF card leading to failure or damage of the card.
- Use the CF card and memory card adaptor in the environment that satisfies the general specifications described in the User's Manual for the GOT used. Not doing so can cause an electric shock, fire, malfunction or product damage or deterioration.

STARTUP AND MAINTENANCE PRECAUTIONS

CAUTION

- Never disassemble or modify the CF card and memory card adaptor. To do so may cause a failure, malfunction, injury or fire.
- Before touching the CF card or memory card adaptor, be sure to touch grounded metal or similar object to discharge the static electricity from human body. Failure to do so may cause a malfunction or failure of the unit.

DISPOSAL PRECAUTIONS

CAUTION

- Dispose of this product as industrial waste.

Manuals

The following shows manuals relevant to this product.

Detailed Manual

| Manual name | Manual number (Model code) |
|------------------------------------------------------|----------------------------|
| GT16 User's Manual (Hardware) (Sold separately) | SH-080928ENG (1D7MD3) |
| GT16 User's Manual (Basic Utility) (Sold separately) | SH-080929ENG (1D7MD4) |
| GT15 User's Manual (Sold separately) | SH-080528ENG (1D7M23) |
| GT11 User's Manual (Sold separately) | JY997D17501 (09R815) |
| GT11 Handy GOT User's Manual (Sold separately) | JY997D20101 (09R817) |

Relevant Manuals

For relevant manuals, refer to the PDF manuals stored in the CD-ROM for the drawing software used.

© 2004 MITSUBISHI ELECTRIC CORPORATION

Compliance with the EMC and Low Voltage Directives

To configure a system meeting the requirements of the EMC and Low Voltage Directives when incorporating the Mitsubishi GOT (EMC and Low Voltage Directives compliant) into other machinery or equipment, refer to "EMC AND LOW VOLTAGE DIRECTIVES" of the General Description included with the GOT used. The CE mark, indicating compliance with the EMC and Low Voltage Directives, is printed on the rating plate of the GOT.

Packing List

The following items are included.

| Model | Product | Quantity |
|--------------------------------------------------------------------------------------------------------------------------------------------------------------------|---------------------|----------|
| GT05-MEM-16MC, GT05-MEM-32MC, GT05-MEM-64MC, GT05-MEM-128MC, GT05-MEM-256MC, GT05-MEM-512MC, GT05-MEM-1GC, GT05-MEM-2GC, GT05-MEM-4GC, GT05-MEM-8GC, GT05-MEM-16GC | CF card | 1 |
| GT05-MEM-ADPC | Memory card adaptor | 1 |

1. OVERVIEW

This User's Manual describes the GOT1000 series CF card and memory card adaptor (hereinafter referred to as the CF card and memory card adaptor). By installing the CF card, OS and project data can be transferred and functions can be increased. Refer to the User's Manual for the GOT used for the applicable GOT. Refer to GT Designer2 Version 1 Basic Operation/Data Transfer Manual for transfer of the OS and project data. Refer to GT Designer2 Version 1 Screen Design Manual for the increased functions. The memory card adaptor converts the CF card into a memory card (TYPE II).

2. SPECIFICATIONS

The performance specifications of the CF card and memory card adaptor are indicated below. The general specifications of the CF card and memory card adaptor are the same as those of the GOT. Refer to the User's Manual for the GOT used for the general specifications of the GOT.

| Model | Memory capacity | Number of write times | Weight | Applicable GOT | | |
|----------------|-----------------|-----------------------|-----------------|-----------------|-----------------|-------|
| | | | | GT 16 | GT 15 | GT 11 |
| GT05-MEM-16MC | 16M bytes | 300,000 times | 0.01kg (0.03lb) | ○ | ○ | ○ |
| GT05-MEM-32MC | 32M bytes | | | ○ | ○ | ○ |
| GT05-MEM-64MC | 64M bytes | | | ○ | ○ | ○ |
| GT05-MEM-128MC | 128M bytes | | | ○ | ○ | ○ |
| GT05-MEM-256MC | 256M bytes | | | ○ | ○ | ○ |
| GT05-MEM-512MC | 512M bytes | | | ○ | ○ | ○ |
| GT05-MEM-1GC | 1G bytes | | | ○ | ○ | ○ |
| GT05-MEM-2GC | 2G bytes | | | ○ | ○ | ○ |
| GT05-MEM-4GC | 4G bytes | | | ○ ^{*1} | X | X |
| GT05-MEM-8GC | 8G bytes | | | ○ ^{*1} | X | X |
| GT05-MEM-16GC | 16G bytes | | | ○ ^{*1} | X | X |
| GT05-MEM-ADPC | - | | | - | 0.02kg (0.05lb) | - |

- *1: A CF card with more than 2GB can be used for the GT16 with the following versions of OSes installed.
- Boot OS version: 05.09.00AF or later
 - Standard monitor OS version: 05.09.00 or later
- If the above versions of OSes are not installed, install the OSes to the GOT by using GT Designer3 Version 1.15R or later. If the OS version is earlier than the above OS versions, a CF card with more than 2GB is not recognized correctly. GT Designer2 Version 1 is not supported.

| Point |
|---------------------------------------------------------------------------------------------------------|
| When formatting a CF card with more than 2GB by using a personal computer, format the CF card to FAT32. |

3. PART NAMES AND EXTERNAL DIMENSIONS

(1) CF card

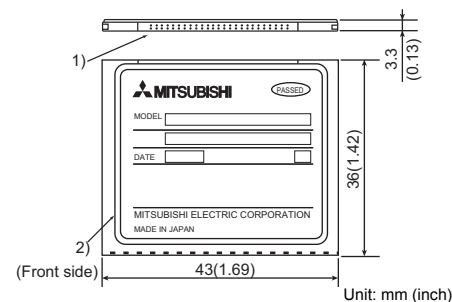

| No. | Name | Description |
|-----|--------------|-------------------------------------------------|
| 1) | Connector | For connecting the CF card interface of the GOT |
| 2) | Rating plate | - |

(2) Memory card adaptor

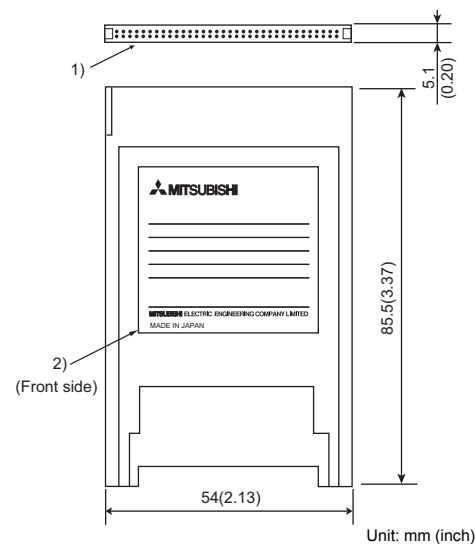

| No. | Name | Description |
|-----|--------------|-------------------------------------------------------------------|
| 1) | Connector | For connecting the memory card interface of the personal computer |
| 2) | Rating plate | - |

4. INSTALLING AND REMOVING PROCEDURES

The installation and removing procedures for the CF card is explained using the GT1575.

4.1 Installing the CF Card

- (1) Turn the CF card access switch of the GOT off.

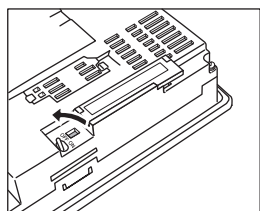

- (2) Open the cover of the CF card interface. Insert and install the CF card into the CF card interface with its front side outside. *1

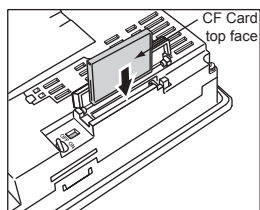

- *1 CF card eject button
For the following GOTs, after installing the CF card, turn the CF card eject button to 90 degree while being pulled.
- GT1585-S, GT1575-S: Hardware version B (April, 2005) or earlier
 - GT1575-V, GT1565-V: Hardware version D (April, 2005) or earlier

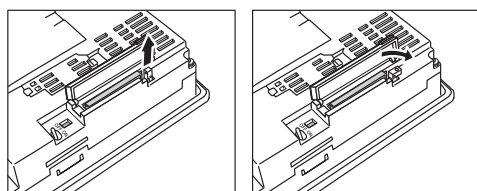

- (3) Close the cover of the CF card interface. Set the CF card access switch to ON.

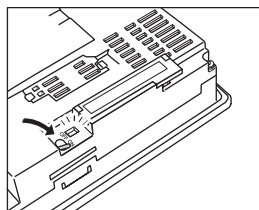

4.2 Removing the CF Card

- (1) Turn the CF card access switch of the GOT off, and make sure that the CF card access LED has been turned off. (When the CF card access LED turns off, the CF card can be removed even during the GOT power on.)

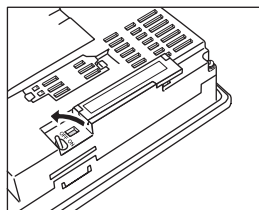

- (2) Push the CF card eject button of the GOT. *2 (The CF card eject button is pulled out after pushing at once.)

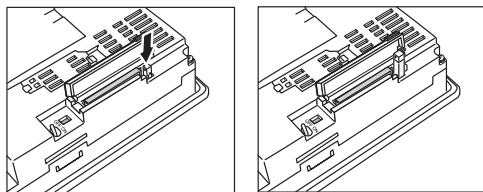

- *2 CF card eject button
For the following GOTs, after opening the cover of the CF card interface, raise the CF card eject button.
- GT1585-S, GT1575-S: Hardware version B (April, 2005) or earlier
 - GT1575-V, GT1565-V: Hardware version D (April, 2005) or earlier

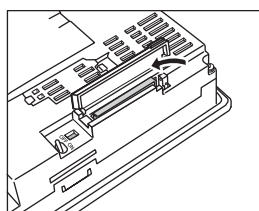

- (3) Push the CF card eject button of the GOT to lift the CF card and remove it.

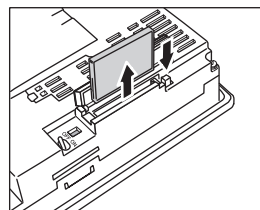

4.3 Precautions for Installing and Removing the CF Card

- (1) While the CF card access LED is on, do not install/remove the CF card or power off the GOT. To do so may cause data corruption or malfunction.
- (2) When ejecting the CF card, support it by hand since it may pop out. Failure to do so may cause a fall of the CF card leading to failure or damage of the card.

Warranty

Mitsubishi will not be held liable for damage caused by factors found not to be the cause of Mitsubishi; machine damage or lost profits caused by faults in the Mitsubishi products; damage, secondary damage, accident compensation caused by special factors unpredictable by Mitsubishi; damages to products other than Mitsubishi products; and to other duties.

For safe use

- This product has been manufactured as a general-purpose part for general industries, and has not been designed or manufactured to be incorporated in a device or system used in purposes related to human life.
- Before using the product for special purposes such as nuclear power, electric power, aerospace, medicine or passenger movement vehicles, consult with Mitsubishi.
- This product has been manufactured under strict quality control. However, when installing the product where major accidents or losses could occur if the product fails, install appropriate backup or failsafe functions in the system.

| Country/Region | Sales office/Tel |
|----------------|------------------------------------------------------------------------------------------------------------------------------------------------------------------------------------------------------------|
| U.S.A | Mitsubishi Electric Automation Inc. 500 Corporate Woods Parkway Vernon Hills, IL 60061, U.S.A. Tel: +1-847-478-2100 |
| Brazil | MELCO-TEC Rep. Com. e Assessoria Técnica Ltda. Rua Correia Dias, 184, Edifício Paraisópolis Trade Center-8 and Paraisópolis, São Paulo, SP Brazil Tel: +55-11-5908-8331 |
| Germany | Mitsubishi Electric Europe B.V. German Branch Gothaer Strasse 8 D-40880 Ratingen, GERMANY Tel: +49-2102-486-0 |
| U.K | Mitsubishi Electric Europe B.V. UK Branch Travellers Lane, Hatfield, Hertfordshire, AL10 8XB, U.K. Tel: +44-1707-276100 |
| Italy | Mitsubishi Electric Europe B.V. Italian Branch Centro Dir. Colleoni, Pal. Persico-Ingr.2 Via Paracelso 12, I-20041 Agrate Brianza, Milano, Italy Tel: +39-039-60531 |
| Spain | Mitsubishi Electric Europe B.V. Spanish Branch Carretera de Rubí 76-80 E-08190 Sant Cugat del Valles, Barcelona, Spain Tel: +34-93-565-3131 |
| France | Mitsubishi Electric Europe B.V. French Branch 25, Boulevard des Bouquets, F-92741 Nanterre Cedex, France TEL: +33-1-5568-5568 |
| South Africa | Circuit Breaker Industries Ltd. Private Bag 2016, ZA-1600 Isando, South Africa Tel: +27-11-628-2000 |
| Hong Kong | Mitsubishi Electric Automation (Hong Kong) Ltd. 10th Floor, Manulife Tower, 169 Electric Road, North Point, Hong Kong Tel: +852-2887-8870 |
| China | Mitsubishi Electric Automation (China) Ltd. 4/F Zhi Fu Plaza, No.80 Xin Chang Road, Shanghai 200003, China Tel: +86-21-6120-0808 |
| Taiwan | Setsumo Enterprise Co., Ltd. 6F No.105 Wu-Kung 3rd Rd, Wu-Ku Hsiang, Taipei Hsine, Taiwan Tel: +886-2-2299-2499 |
| Korea | Mitsubishi Electric Automation Korea Co., Ltd. 1480-6, Gayang-dong, Gangseo-ku Seoul 157-200, Korea Tel: +82-2-3660-9552 |
| Singapore | Mitsubishi Electric Asia Pte. Ltd. 307 Alexandra Road #05-01/02, Mitsubishi Electric Building, Singapore 159943 Tel: +65-6470-2460 |
| Thailand | Mitsubishi Electric Automation (Thailand) Co., Ltd. Bang-Chan Industrial Estate No.111 Moo 4, Serithai Rd, T.Kannayao, A.Kannayao, Bangkok 10230 Thailand Tel: +65-2-517-1326 |
| Indonesia | P.T. Autoteknindo Sumber Makmur Muara Karang Selatan, Block A/Utara No.1 Kav. No.11 Kawasan Industri Pergudangan Jakarta - Utara 14440, P.O.Box 5045 Jakarta, 11050 Indonesia Tel: +62-21-6630833 |
| India | Messung Systems Pvt. Ltd. Electronic Sadan NO:III Unit No15, M.I.D.C. Bhosari, Pune-411026, India Tel: +91-20-2712-3130 |
| Australia | Mitsubishi Electric Australia Pty. Ltd. 348 Victoria Road, Rydalmere, N.S.W 2116, Australia Tel: +61-2-9684-7777 |

MITSUBISHI ELECTRIC CORPORATION
HEAD OFFICE: TOKYO BUILDING, 2-7-3 MARUNOUCHI, CHIYODA-KU, TOKYO 100-8310, JAPAN
NAGOYA WORKS: 1-14, YADA-MINAMI 5-CHOME, HIGASHI-KU, NAGOYA, JAPAN

When exported from Japan, this manual does not require application to the Ministry of Economy, Trade and Industry for service transaction permission.

Specifications subject to change without notice.
Printed in Japan, April 2011.